

# LSA REPORTER

Executive Editor—Sal Dulcamaro, CML

Newsletter Staff—Alvin Moebus—William M. Lynk, CRL

LSA Website: <http://home.earthlink.net/~lsamichigan>



*The Old Becomes  
the New!*

## BREAKING NEWS!!! NEW LSA NEWSLETTER FORMAT

In order to provide our membership with a more informative, educational and entertaining monthly update, The Locksmith Security Association has introduced a more cohesive newsletter. We will be providing more services and information for our members, including: Member of the Month, Tech Tips, Contact, Events, Classified Ads, Contests, IC Corner, PRP News and Industry News & Issues, to name a few. We will even place, somewhere in the upcoming Newsletters, members names with their membership numbers. If they attend the subsequent LSA meeting, they can claim their **prize!**

The LSA Reporter will also be on the web, online—in FULL COLOR—for your convenience at:

<http://home.earthlink.net/~lsamichigan>. We hope the LSA Reporter will evolve into an invaluable tool for all members. Let us know your ideas, comments and direct submissions to: [lsamichigan@earthlink.net](mailto:lsamichigan@earthlink.net). Thanks. —Newsletter Staff



## LSA INFORMER—HOT NEWS FOR YOUR INFORMATION

.....just luv that pic of **John Hubel, CML** in the Sept. issue of *Keynotes!* I think it makes him look 12 years younger...WOW!....I just hope he quits feeding **Caesar** (LSA Mascot) the FULL BAG of dog biscuits at the LSA meetings! He just does it to see if the dawg will puke. Sources say IT DOES NOT HAPPEN. Sorry, Johnnie!! But then there's no "sorry" with the retirement of the great **Lynn Brancheau, CML** formerly with Daimler-Chrysler who volunteered to assist **Bill Lynk, CRL** with the two IC classes he taught at the recent ALOA Convention. They sparred at each other and the classes laughed hysterically. I understand that Lynn & Bill are at odds about HOW TO READ AN IC Chart. The late **Gerry Finch** would support Lynn but the late **A.J. Hoffman, CML** would support Bill. Regardless, the students were in awe with their quick-wit repartee, but in the end, who won? **John Paull, CRL**, just sat there with a smirk on his face! Time will tell. Speaking of time.....when you need a quick fix on an electronic lock part, call **Ray Sinai**. He certainly knows "*Electrics*," as the British say, and this is his specialty. My "specialty" as the Secret LSA Informer is to **TELL**. I must go now and scrounge up some more lock & key dirt. Ba-bye-- [NOTE: If YOU know of TOP SECRET information about LSA Members, it is strongly suggested that you report it immediately to us at the e-mail address of: [LsaMichigan@earthlink.net](mailto:LsaMichigan@earthlink.net) so that it can be scrutinized, evaluated, and filtered, then disseminated to our members. ]



## INDUSTRY NEWS & ISSUES

**DEATH NOTICE:** It is with regret that we must report the passing of **Gary M. Rusmiser**, a locksmith from Bay City, Michigan. He left us on early on June 16, 2005 at age 49. He worked as a locksmith since age 15 and was the owner and founder of Gary's Lock Service since 1986. He is survived by his wife, Sue Perkins.

**ALOA TO HELP SOUTH:** A letter was sent out by Charles W. Gibson, Jr. to all ALOA members encouraging donations for those locksmiths affected by Hurricane Katrina. They have identified some who need help. Visit the ALOA website at: [www.aloa.org](http://www.aloa.org) for more information.

→**RORABCK & SIMON TO APPEAR!**: No, it's not a musical event, but it still has celebrity status. **Jerry Roraback**, the Executive VP of LAB, Inc., along with **Gene Simon**, the REP for LAB will present at the November LSA Meeting in Metro Detroit. **You MUST be there!** Details are unfolding as we go to press.....stay tuned.

**EDUCATION & PRP NEWS—ROBERT NOBLE, CML**

**Education:** That is the "key" to "unlocking" your future. We at LSA are striving to bring you the education you ask for. From product reviews at the meetings, to workshops sponsored by Distributors and Manufacturers (the Gardall Workshop at IDN), and A.C.E. classes on Saturdays, the information provided may just make you richer in both knowledge and finances.

Check the LSA calendar for the next few months and you will have a sampling of topics coming your way. Scheduled are Obering and Associates, LAB presented by Jerry Roraback, and our own William Lynk, CRL doing a class on Large Format IC!

Some classes are free, some cost a little. **Invest in yourself, invest in your education, invest in your future!**

If you want a class on a topic we have not scheduled, let us know. As an added feature, if you think of a class topic and are willing to chair the scheduling and promoting of that class, you may attend the class for FREE, regardless of the cost.

See you at class!

Robert Noble, CML—Education Director for LSA

## NEXT LSA MEETING

THURSDAY,  
OCTOBER 13TH  
AT 7:30 P.M.

**TECH TIPS**

This month's Tech Tip comes from member, *James Whidden, CRL*. Indirect Drive locks can either be Top Drive, End Drive or Bottom Drive. The term "indirect" simply indicates the wheel pack is offset somewhere and is not directly behind or in line with the dial of the safe. The offset will vary between lock models and the rotation of the wheel pack is achieved by gearing.

**PRP GLOSSARY—KEEPING YOU "IN THE KNOW"**

*milling runout* (n) - the distinctive shape caused by the curved surface milling cutters at the bow end of a key blade

*stump* (n) - the stationary fence(s) in a lever lock

**LSA OFFICERS**

President—**Maurice Horne, CML** (313) 550-5810

Vice President—**Michael Buda** (313) 730-1075

Treasurer—**Larry Walker, CRL** (313) 350-1641

Secretary/Ombudsman—**Elmer Carver** (313) 493-0117

Education Chairman—**Robert Noble, CML** (810) 385-9329

Membership Chairman/Newsletter Executive Editor—**Sal Dulcamaro, CML** (586) 791-5416

**Locksmith Security Association** meets at 7:30 p.m., the second Thursday of the month (Sept. to June) in the Metro Detroit Area in southeast Michigan.

UAW Hall  
1640 Stephenson Hwy.,  
just north of Maple (15 Mile Rd.),  
on the east side of street

We're On the Web! [Case-SeNsItIvE!]

<http://home.earthlink.net/~lsamichigan>

**LSA MEMBER OF THE MONTH—LEN MILLER, RL**

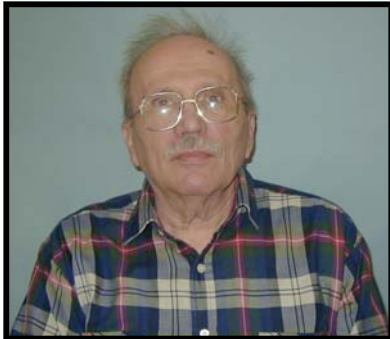

**T**his month we introduce to you **Len Miller, RL**. Len has been using his locksmith skills for over 60 years. After his Air Force discharge as a radar mechanic, Len started the Miller Pro Hardware store on 7 Mile & Schaffer in Detroit. After 50+ years in that business, Len sold his business and began working for *Ray Sinai* for

nearly a decade. His mother is 100 years young! This tells us, Len, that you have many, many more years ahead of you to help out locksmiths across Metro Detroit. Does any one know those key blank charts as well as Len? Probably not!

Len has been a member of LSA for many, many years! Congratulations to you on becoming the first, prestigious **LSA Member of the Month!** - *Newsletter Staff*



**“Qwik-Qwiz”**

“ A 161 Door Prep is usually considered \_?\_.”

- a) commercial
- b) residential
- c) UL437-rated
- d) useless, by ALOA Standards

*[answer on next page]*

**IC CORNER—WILLIAM M. LYNK, CRL**

**CorbinRusswin LFIC**

The standard CorbinRusswin large format interchangeable core has the control chambers located in chambers 2 through 5. These chambers will contain build up pins (control pins) and can be determined by using a build up pin formula, employing (+) and (-) pin sizes. The formula is:

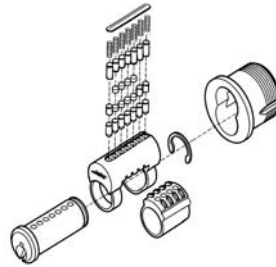

$$(CTL\ Cut + 0) - (Plug\ Total) = Build\ Up\ Pin$$

**WEB LINKS**

**ALOA**  
www.aloa.org

**The Lockwriter**  
http://home.earthlink.net/~lockwriter

**ClearStar Security Network**  
www.clearstar.com

**LAB**  
www.labpins.com

**DID YOU KNOW....**

LOCKS WERE USED BY THE ANCIENT EGYPTIANS?



**CALENDAR OF LSA EVENTS**

October 13, 2005—Meeting: 7:30 p.m.; **Mel Smith**, Hardware Agents, DETEX – PDQ

November 10, 2005—Meeting: 7:30 p.m.; **Jerry Roraback** from LAB

November 12, 2005—A.C.E. LFIC Class—8:00a.m. to 5:00 p.m.; Instructor **William Lynk, CRL**;

**(ALOA MEMBERS ONLY - PRP Elective P-L-39 AFTER Class)**

December 8, 2005—Meeting 7:30pm; ?Holiday Dinner? 6:30 p.m. if association wishes; Speaker **John Hohausler**, Oberting & Associates - RCI

→For those who live far: Battle Creek, Kalamazoo or even Cheboygan!!!!, your time attending our meetings is well spent. Let us know how we can help you be a better locksmith professional.

“Education, Knowledge & Cooperation—LSA”



Caesar—Ready to play.....then combinate cores.

-LSA Mascot



**LOCKSMITH SECURITY  
ASSOCIATION OF MICHIGAN**

533 Fisher Road  
Grosse Pointe, MI 48230

Phone: (313) 885-9365

Email:  
LSAMichigan@earthlink.net

**Bookmark the LSA Website.** It might  
be 'tuff at first, but then it's a breeze!  
<http://home.earthlink.net/~lsamichigan>

**CLASSIFIED ADS**

For Sale:

WANTED: Locksmith:

***YOUR ad could be here!!!!***

***Free: LSA always has free items for members who attend the meetings!***

Qwik-Qwiz:

Answer is A. The 161 prep has a backset of 2-3/4", usually considered commercial.

**Associate Members of LSA**

**Bockert & Associates**

18 Fort Monroe Industrial Parkway  
Monroeville, OH 44847

**(800) 321-7550**

FAX: (419) 465-4216

**Manufacturer Reps for:**

ABUS, ARROW, ASSA, DON JO,  
H.E.S., HPC, LOCKCRAFT,  
SECURAKKEY, SECURITRON,  
DEDICATED MICROS, TAKEX,  
VIDEOLARM, MEDECO

**IDN-Hardware Sales, Inc.**

35950 Industrial Road  
P.O. Box 510624  
Livonia, MI 48150

**Livonia: (800) 521-0955**

**FAX: (800) 272-4409**

**Warren: (800) 468-7490**

**FAX: (586) 755-5145**

*Your Key to Security Hardware*

***ICLS***

*Interchangable Core  
Lock Systems*

***William M. Lynk, CRL***

*IC Specialist/IC Author  
ALOA, ASIS, LA, LSA, ClearSer  
Certified ALOA A.C.E. Instructor*

**♦ IC Products ♦ IC Tools  
♦ Dist. For Xpernetik/Ultra Security**

**Phone: (313) 884-9800**

**E-mail: [icls@earthlink.net](mailto:icls@earthlink.net)**

**Web: <http://home.earthlink.net/~icls>**

**LAB**

**THE CHOICE OF**

\*Professional Locksmiths  
\*Finest Lock Companies

700 Emmett St.  
Bristol, CT 06010

**(800) 243-8242**

**FAX: (860) 583-7838**

**JLM Wholesale, Inc.**

3095 Mullins Ct.  
Oxford, MI 48371

**(800) 522-2940**

**FAX: (800) 782-1160**

*Wholesale Hardware*

**RITTNER/FRENCH  
ASSOCIATES**

150 S. Elizabeth  
Rochester, MI 48307

**(800) 732-4773**

**1-800-RFA-4-SPEC**

**FAX: (248) 651-2650**

This Space

Could Be  
Yours!

**Your Company  
Would Look Great  
In This Location**

**THIS AREA  
IS  
AVAILABLE  
FOR  
YOU!**

Be proud of  
your Business.  
Our Rates are  
**Excellent!**

***Can You  
Fill This  
Box?***

Let LSA Tell  
**Everyone**  
About Your  
**Superb Business**  
Right Here!



**PRESIDENT'S MESSAGE—MAURICE HORNE, CML**

At the meeting last month, John Hohausser gave an excellent presentation on the Alarm Lock product. There was also some valuable information from the members who shared some tricks of the trade. It's time to pay our yearly membership dues again. By the end of the last meeting there were about 23 paid up members. If you haven't paid your dues, then you can mail them in or bring them to the next meeting. Dues are \$45.00. For our October meeting our guest speaker will be Mel Smith from Hardware Agents. He will talk on the Detex – PDQ line of product. As you may be aware, Hurricane Katrina has caused a considerable amount of damage to the Alabama, Mississippi, Louisiana, and New Orleans area. ALOA would like to assist those locksmiths who have lost their shops, tools and equipment by asking other locksmith for help. If you would like to help, then your donations can be made by going online at [www.aloa.org](http://www.aloa.org) or by mailing donations directly to: Associated Locksmith of America, Inc, 3500 Easy Street, Dallas Texas 75247. You can also call ALOA directly at: (214) 819-9733. Keep your eyes on the upcoming calendar for new classes coming up. There will be a board meeting for all board members one hour before our regular meeting. This meeting will begin at 6:30 p.m., and the regular meeting will begin at 7:30 p.m. I hope to see you at the meeting.

*Maurice Horne, CML*



**EDITOR'S NOTE—SAL DULCAMARO, CML**

Most of you know that I have been maintaining an overextended workload for most of my time with LSA. I have not been able to maintain my level of involvement with LSA in recent times for a variety of reasons, and my time will probably be somewhat limited in the immediate and near future. I will still be around and will try to do what I can as circumstances allow. As my situation changes and sorts out, I hope to increase my involvement in LSA in the not too distant future.

*Sal*



# LARGE FORMAT INTERCHANGEABLE CORE

Taught by: William M. Lynk, CRL, ALOA A.C.E. Certified Instructor

Nov 12, 2005

8:00 am until 5:00 pm



LSA is presenting an ACE Class on LARGE FORMAT INTERCHANGEABLE CORE. This class covers the principles and techniques applying to most Large Format Interchangeable Cores, including Yale, CorbinRusswin, Medeco, Schlage, Sargent, Kaba and ASSA. These are important products for commercial and institutional applications.

Product characteristics related to construction, operation and keying are discussed, explained, and shown by exploded views and sample cores. Students will learn rules for selecting TMK's and control keys, as well as work through pin stack calculations. Manufacturer-specific rules for master key systems using their cores will also be covered.

Class exercises include hands-on work disassembling/reassembling cores, decoding for the control key, calculating pin stacks and combining select cores from Schlage, CorbinRusswin Sargent, Medeco, Kaba, ASSA and Yale. Students will also receive technical handouts and manufacturer-specific information, useful in servicing LFICs.

*Prerequisite: Students should have a solid understanding of basic master keying.*

## Materials to bring to class:

- **Key caliper/micrometer;**
- **Book: "Removable Cores: Large Format" - published by TNL is extremely helpful and will be the basis of the organization of the material presented in class.** It can be purchased through:
  - National Publishing Company/The National Locksmith: (630) 837-2044 in Chicago, IL
  - The Associated Locksmiths of America (ALOA): (214) 827-1701 in Dallas, TX



*This class will help in the PRP Study Applications: PRP Section L-39. ALOA Members who pay the additional lab fee for the test may take PRP Section L-39 at the end of the day, immediately after the class.*

**William M. Lynk, CRL**, has been a locksmith since 1975, is an IC Specialist, and is an industry author having penned ***Interchangeable Cores: Small Format*** ©2000, ***Removable Cores: Large Format*** ©2003 and ***SFIC: Advanced*** ©2005. He is a certified ALOA A.C.E. Instructor, teaching full-day classes on SFIC and LFIC at the ALOA Convention and across the country, as well as a member of ASIS, ILA, LSA and a Sponsor for ClearStar Security Network. Bill, the owner of ICLS (*Interchangeable Core Lock Systems*), has also originated SFIC Technical Manuals for both domestic and international lock companies while maintaining a close working relationship with the major lock and security manufacturers throughout the world.

**COST: Non-Member \$125.00**

**LSA Member \$75.00**

**Pre-pay by check by November 1, 2005**

Make check payable to: **LSA;**

Send check to: LSA, c/o Robert Noble, CML, 2670 Grace Road Fort Gratiot, MI 48059

**Space is limited. Call for reservations:**

Robert Noble, CML at 810-385-9329 or email [noblelock25@sbcglobal.net](mailto:noblelock25@sbcglobal.net)

The class will be held at the: **Holiday Inn Express** (Hotel phone number for rooms 586-285-5800)  
**31900 Little Mack, Roseville, MI 48066**

