

LSA REPORTER

Executive Editor—Sal Dulcamaro, CML

Associate Editor—William M. Lynk, CRL * Associate Editor—Alvin Moebus

Publication Deadline: Submit items Two (2) Weeks (14 calendar days) prior to the LSA meeting date.

LSA Website: <http://home.earthlink.net/~lsamichigan> (case sensitive)



PRESIDENT'S MESSAGE—MAURICE HORNE, CML

The Holidays are here and the New Year is standing at our door. We had a delicious holiday meal at the last meeting and many came out to enjoy. We had about 45 in attendance at our last meeting with about 6 or 7 visitors and many of them joined LSA during that meeting. Our membership is at about 75 paid up members. We still have 6 months left in this quarter so I'm sure that we can reach the goal of 100 paid up members by June 1, 2006. If everyone would contact our former members, and invite new ones to come then we can reach the goal of 100 easily. We had a very good meeting and there were lots of door prizes given away. Pay close attention to the calendar for upcoming classes. There is a Basic Electricity & Electronics class coming in February and a full PRP test is scheduled in March. Take advantage of the top quality classes that LSA is offering. There will be a board meeting at 6:30 p.m., one hour before our January meeting. Everyone is invited. I hope that the year of 2005 was a prosperous year for everyone, and hopefully 2006 will be a better year. Have a safe and happy holiday, and I will see you at the January meeting.

—*Maurice Horne, CML*



INDUSTRY NEWS & ASSOCIATION ISSUES

REQUIREMENTS TO MAINTAIN PRP CERTIFICATION/ALOA MEMBERSHIP—As you may know, significant changes will be taking place as of January 1, 2006. Those [who] achieved their designations prior to 1/1/06 are exempt from ALOA Education Department requirements for recertification; however they will have to comply with the ALOA Active membership requirements to have and maintain an ALOA recognized certification. To examine the point system that ALOA has created for those requiring recertification, please refer to the complete 5-page write-up in *ALOA Keynotes, December 2005* issue for more details.



EDUCATION & PRP NEWS—*ROBERT NOBLE, CML*

Happy New Year! LSA is working hard to bring the membership many informative topics over the next few weeks. **JOHN BOCKERT** from Bockert and Associates will be doing a presentation at the January meeting. We have **MARY HESTER** from JLM Wholesale scheduled for the February meeting. Sign up now for the ALOA ACE Basic Electricity and Electronics class scheduled for February 11, 2006, with PRP L-13 available after the class.

Speaking of the PRP, LSA is hosting a PRP sitting on March 11, 2006. I have registration forms available. We have a couple volunteers who will meet and lead a PRP study group. If you are planning on sitting for the PRP and want someone to help you study for the mandatory section, let me know and we will get an evening session scheduled.

As more LSA events are scheduled they will be posted into the LSA calendar. Keep checking the web site for updates.

-Robert Noble, CML

NEXT LSA MEETING

THURSDAY,
FEBRUARY 9TH
AT 7:30 P.M.



TECH TIPS—BY MIKE SMOLAREK

When servicing an electronic safe lock (or even access controlled door hardware) it is always wise to put fresh batteries in the device regardless how recent the customer indicated it was done. Two out of three times it will be necessary anyway, and the third time reduces the call-back potential. Purchase your batteries from a source that practices high volume turn over. This, too, helps insure freshness of the batteries.

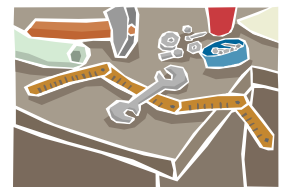

Locksmith Security

Association meets at 7:30 p.m., the second Thursday of the month (Sept. to June) in the Metro Detroit Area in southeast Michigan.

UAW Hall

1640 Stephenson Hwy., just north of Maple (15 Mile Rd.), on the east side of street.



PRP GLOSSARY—KEEPING YOU “IN THE KNOW”

maison key system n. [from the French meaning “house”] a keying system in which one or more cylinders are operated by every key (or relatively large number of different keys) in the system; e.g., main entrances of apartment buildings operated by all individual suite keys of the building

We're On the Web! [Case-SeNsItIvE!] <http://home.earthlink.net/~lsamichigan>



LSA MEMBER OF THE MONTH—LORENZO WHITE

The featured member this month, Lorenzo White, got interested in locksmithing when at the age of 15 watched his brother Impressioning keys. As a high school student, Lorenzo attended Brightoff Vocational Technical in Detroit. He then started into the trade on his own. After 15 years in the business, he states that, "Impressioning keys is still his favorite thing to do". He further told me that he made CRL in one year. So Lorenzo must have many talents as a locksmith. Lorenzo

said, "That automotives is his greatest challenge". He is married with three children and has been a member of LSA for 7 years. I have attended classes, PRP study sessions, and LSA meetings with Lorenzo and can attest of his integrity and passion for the Locksmith Industry.

-by Al Moebus



"Qwik-Qwiz"

Safe dial manipulation is accomplished by dial readings taken at the:

- A) contact points
- B) changing index
- C) drill point
- D) fence location

[answer on next page]

IC CORNER—WILLIAM M. LYNK, CRL

SCORPION SFIC - The Scorpion CX-5 Security SFIC is similar to most SFICs (Arrow, BEST, Falcon, ULTRA, Schlage, KSP, etc.) with regard to servicing. The security sidebar does not play a role in the combining (pinning) of the core, or in the origination of the key. These two factors are determined at the factory and are of no consequence to those who must combine cores or originate keys, since the sidebar rests inside the plug of the core (unnecessary to dismantle) and the key blank with matching sidebar grooves are predetermined at the time of key blank manufacturing. The Service manual I wrote for Scorpion (Montréal, Canada) is in the LSA Resources, for more information..

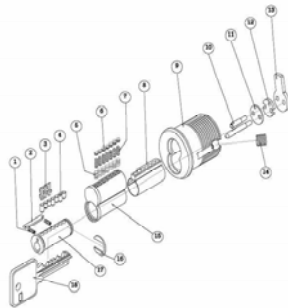

Please Drive Safely! - A Public Service Announcement from Caesar



-LSA Mascot

CALENDAR OF LSA EVENTS—SEE WEBSITE FOR COMPREHENSIVE LIST

2006

- January 12—LSA Meeting 7:30pm; John Bockert, Bockert and Associates; 6:30 Board Mtg.
- February 9—LSA Meeting 7:30pm; Mary Hester, JLM Wholesale
- Feb 11—LSA Class ALOA Basic Electricity [with PRP L-13] 8:00 a.m. -5:00 p.m.
- March 9—LSA Meeting 7:30pm; John Hohausser, RCI
- March 11—Full PRP Sitting 8:00 am Saturday; Holiday Inn Express, Roseville, MI
- April 13—LSA Meeting 7:30pm; Open nominations for officers

"Education, Knowledge & Cooperation—LSA"

WEB LINKS

ALOA
www.aloa.org

The Lockwriter
http://home.earthlink.net/~lockwriter

ClearStar Security Network
www.clearstar.com

LAB
www.labpins.com



**LOCKSMITH SECURITY
ASSOCIATION
OF MICHIGAN**

533 Fisher Road
Grosse Pointe, MI 48230

Phone: (313) 885-9365

Email:
lsamichigan@earthlink.net

**Bookmark the LSA Website. It might
be 'tuff at first, but then it's a breeze!
<http://home.earthlink.net/~lsamichigan>**

CLASSIFIED ADS—SEE LSA WEBSITE FOR UPDATES

◆For Sale: Free for the asking - 4 Yale door closures and 2 LCN
Door closures (one is a parallel arm) None of them are leaking as yet.

Call Al Moebus 313 885 9365

◆2001 Maytag Atlantis gas dryer \$150 and washer \$100.

Call Mark Konwinski 313-563-0597

Free: LSA always has free items for members who attend the meetings!

Qwik-Qwiz:

Answers A: contact points

Associate Members of LSA

Bockert & Associates

18 Fort Monroe Industrial Parkway
Monroeville, OH 44847

(800) 321-7550

FAX: (419) 465-4216

Manufacturer Reps for:

ABUS, ARROW, ASSA, DON JO,
H.E.S., HPC, LOCKCRAFT,
CANSEC, SECURITRON, CBC,
MERIT, TAKEX, MEDECO

IDN-Hardware Sales, Inc.

35950 Industrial Road
P.O. Box 510624
Livonia, MI 48150

Livonia: (800) 521-0955

FAX: (800) 272-4409

Warren: (800) 468-7490

FAX: (586) 755-5145

Your Key to Security Hardware

ICLS

*Interchangable Core
Lock Systems*

William M. Lynk, CRL

*IC Specialist/IC Author
ALOA, ASIS, LA, LSA, ClearSer
Certified ALOA.A.C.E. Instructor*

◆ **IC Products** ◆ **IC Tools**
◆ **Dist. For Xpernetix/Ultra Security**

Phone: (313) 884-9800

E-mail: icls@earthlink.net

Web: <http://home.earthlink.net/~icls>

LAB

THE CHOICE OF

*Professional Locksmiths
*Finest Lock Companies

700 Emmett St.
Bristol, CT 06010

(800) 243-8242

FAX: (860) 583-7838

JLM Wholesale, Inc.

3095 Mullins Ct.
Oxford, MI 48371

(800) 522-2940

FAX: (800) 782-1160

Wholesale Hardware

**RITTMER/FRENCH
ASSOCIATES**

150 S. Elizabeth
Rochester, MI 48307

(800) 732-4773

1-800-RFA-4-SPEC

FAX: (248) 651-2650

Gene Simon

HARDWARE SPECIALIST

Phone: (708) 799-8783

FAX: (708) 799-4322

P.O. Box 51
Flossmoor, IL 60422

Representing:

Jet Hardware Mfg. Corp.
LAB Security Products
Major Manufacturing, Inc.

Ultra Security /

XPERINETIX

*Manufacturer of Premium
Interchangeable Core Systems, Innovative
IC Service Tools
and Ground-Breaking IC Products*

17560 Matinal Drive
San Diego, CA 92127-1240
Phone: (800) 698-7477

www.UltraSecurityUSA.com

E-mail: ultrasec@san.rr.com

DISTRIBUTOR: ICLS * Phone: (313) 884-9800

ELECTED OFFICERS:

President—**Maurice Horne, CML** (313) 550-5810 Treasurer—**Larry Walker, CRL** (313) 350-1641

Vice President—**Michael Buda** (313) 730-1075 Secretary—**Elmer Carver** (313) 493-0117

APPOINTED OFFICES:

Education Chairman—**Robert Noble, CML** (810) 385-9329

Membership Chairman/Newsletter Executive Editor—**Sal Dulcamaro, CML** (586) 791-5416

Membership Secretary—**Alvin Moebus** (313) 885-9365

Ombudsman—**Elmer Carver** (313) 493-0117

Newsletter Associate Editor—**William M. Lynk, CRL** (313) 884-9800

Newsletter Associate Editor—**Alvin Moebus** (313) 885-9365

Sargent-At-Arms—**John Bradford**

Webmaster—**William M. Lynk, CRL** (313) 884-9800



Basic Electricity & Electronics

Instructor: Adam Black, CRL, ALOA A.C.E. Certified Instructor

February 11, 2006

8:00 am until 5:00 pm



*The information presented will be useful in preparing for PRP section L-13. **ALOA Members** who pay the additional \$15.00 lab fee for the test may take PRP Section L-13 immediately after the class. Lab fee \$15.00 payable to ALOA Instructor.*

LOCKSMITH SECURITY ASSOCIATION is pleased to present an ALOA A.C.E. Class: **Basic Electricity & Electronics**. This course begins with fundamental electric theory and focuses on those aspects of electricity that apply to modern access control and electric locking systems.

The class will explore the basics of electronics pertaining to the electronic access control industry. We will explore how electricity is created and utilized. We will also look at the various relationships regarding electricity and how that pertains to the selection of hardware and troubleshooting procedures. To fully participate in this class Students are encouraged to bring their own **digital volt ohm meter, multi-tip screw driver, pocket screwdriver, needle nose pliers, and wire strippers and small hand held calculator.**

Adam Black, CRL has been in the locksmithing profession since 1981 starting with Vincent Safe and Lock in Bakersfield California. He has been with Cothron's Safe and Lock since 1997. He has instructed classes in Access Control, Safe Lock Servicing, Impressioning and Picking and is currently an instructor for Cothron's School of Professional Locksmithing in Austin, Texas.



COST: Non-LSA Member \$165.00
LSA Member \$110.00



Pre-pay by check by February 1, 2006

Make check payable to: **LSA**

Send check to: LSA, c/o Robert Noble, CML, 2670 Grace Road Fort Gratiot, MI 48059

Space is limited. Call for reservations:

Robert Noble, CML at 810-385-9329 or email noblelock25@sbcglobal.net

The class will be held at the: **Holiday Inn Express** (Hotel phone number for rooms 586-285-5800)
31900 Little Mack, Roseville, MI 48066

ALOA PRP/SAVTA STPRP Registration Form

IMPORTANT: PHOTO ID REQUIRED FOR ADMITTANCE TO EXAM ROOM

Sitting Code

M	I	0	3	1	1	0	5
---	---	---	---	---	---	---	---

EVALUATION INFORMATION

Sponsor: LSA - MI

Date: Sat. 03-11-06 Time: 8:00 am

Location: Holiday Inn Express-31900 Little Mack

City: Roseville ST MI ZIP 48066

CANDIDATE (please type or print):

Last Name: _____

First Name: _____ MI: _____

Address: _____

City: _____ State: _____ Zip _____

Work Phone: _____

Home Phone: _____

Previous Member Number (if applicable): _____

Email: _____ @ _____

Have you ever taken the PRP/STPRP before? Yes No

MEMBERSHIP STATUS:

Application will not be accepted at the member rate without valid current membership number.

ALOA Member Number _____

SAVTA Member Number _____

Non-member

Pending (Membership Application Attached)

FORM OF PAYMENT:

Cash Check Number _____

(Make checks payable to ALOA)

Credit Card Payment (choose one):

Visa MasterCard Amex Discover

(Name on Card) _____

(Card Number) _____

(Signature) _____ (Expiration Date) _____

FEES:

Locksmith PRP

ALOA Member \$ 70.00

Non-Member \$ 225.00

SafeTech PRP

SAVTA/ALOA Member \$ 100.00

Non-Member \$ 255.00

PRP Registration \$ _____

Resource Guide @\$20.00 \$ _____

CPS Prep Manual @\$135.00 \$ _____

Membership Dues \$ _____

New Member Application Fee \$ WAIVED

Late Registration Fee (\$10.00) \$ _____

Total \$ _____

DO NOT SEND TO SPONSOR

RETURN THIS FORM WITH THE REQUIRED FEE TO:

ASSOCIATED LOCKSMITHS OF AMERICA, INC

3500 EASY STREET • DALLAS, TX 75247-6416

IF PAYING BY CREDIT CARD, FORM MAY BE FAXED TO:

214-819-9736

LEVEL TESTING FOR:

CRL CPL CML CPS

Below are descriptions of each level and its requirements.

- **CRL Level:** L-00 + two (2) Electives. Choose the Mandatory and two (2) Electives.
- **CPL Level:** CRL + twelve (12) Electives. *On the first attempt*, you may take up to (12) electives. Do not choose any Electives passed previously for CRL.
- **CML Level:** CPL + nine (9) Electives. Choose up to nine (9) Electives. Do not choose any Electives passed previously for CRL or CPL.
- **Re-Take CRL Level:** If you did not pass the Mandatory, you must choose the Mandatory. You may also take one (1) or two (2) Electives if you did not pass one (1) or two (2) Electives, but you may not take extras.
- **Re-Take Other Level:** If you passed the Mandatory, choose any nine (9) Electives.
- **CPS Level (S-00):** Because of the time required this cannot be taken with any other selection.

Note: Application will be returned if choices are not indicated

Mark with an X to indicate your category choices.

CAT#	Description
L-00	Mandatory Categories
L-03	Domestic Auto
L-04	Foreign Auto
L-05	Door Closers
L-07	Life Safety Codes & ADA
L-08	High Security Cylinder Servicing
L-11	Special Applications Cylinder Servicing
L-12	Tubular Key Cylinder Servicing
L-13	Basic Electricity
L-16	Exit Hardware & Exit Alarms
L-20	Keyless Mechanical Locks
L-21	Lever Locks, Other Than Safe Deposit
L-22	Motorcycle Locks
L-24	Safe Combination Locks
L-25	Safe Deposit Locks
L-26	Time Locks,
L-28	Lockset Installation
L-31	Advanced Master Keying
L-32	Safe Installation
L-33	Safe Opening and Servicing
L-34	Vault Installation and Service
L-38	Small Format Interchangeable Core
L-39	Large Format Interchangeable Core
L-40	Electro-mechanical Access Control
L-41	Door-Related Hardware
L-42	Alarms
L-43	Detention Locks
S-00	Certified Professional SafeTech (CPS)

WARNING:

This PRP Registration must be received at ALOA no later than **15 days** prior to test date